



# **RAILOCK**<sup>TM</sup>

Mounting Brackets  
& Hand Rail...

...They're Meant To Be Together



# RAILOCK™

## A Mounting Bracket System For Wood Handrail

### FEATURES

**RAILOCK** Mounting Brackets have been designed for mounting wood handrails; especially for mounting 2"x6" "safety" handrail and similar wood handrails.

**RAILOCK** Mounting Brackets provide the beauty of wood. The warm natural beauty of large wood handrails is appealing and desirable in homes, hospitals, nursing homes, professional buildings, institutions, and the list goes on...

**RAILOCK** Mounting Brackets are strong. When properly installed will meet or exceed ANSI Standard A12.1-1973

**RAILOCK** Mounting Brackets are easy to install. A contractor will find the ease of installation will save time and money. The mounting bracket works the same, whether the railing run is for a hallway or down a flight of stairs.

**RAILOCK** Mounting Brackets offer stability and removability. With just a turn of a wrench, you can remove the railing. This feature will come in handy for painting, wall-papering or maybe you need that extra inch or two to get the washer and dryer down the stairs.

### SPECIFICATIONS

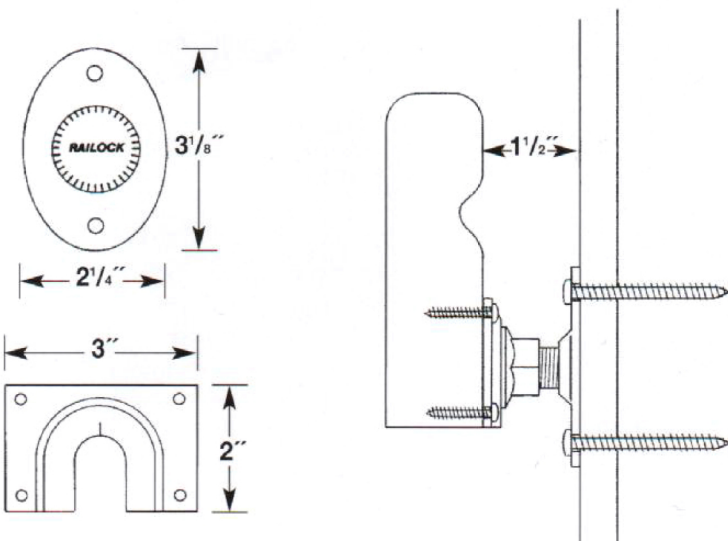

### INSTALLATION

Step 1

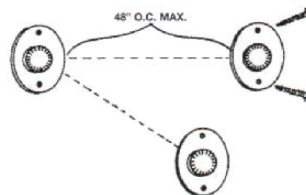

Determine proper height of railing and placement of oval wall brackets. Mark the location of the two screw holes for each bracket. Drill appropriate sized pilot holes and fasten each bracket with two #12 x 2 1/2" screws provided.

Step 2

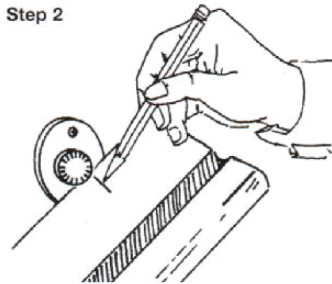

Hold the railing up to the mounting head of the wall bracket. Select the closest "line-up" mark that touches the railing and draw a line square with the railing. Use a square to extend the line 1 1/2" from the bottom of railing.

Step 3

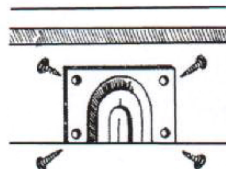

Place the rail pieces flush with bottom of railing so that the "scribe mark" lines up with each line on the railing. Mark the location of the four screw holes for each rail piece. Drill appropriate sized pilot holes and fasten each piece with four #10 x 1" screws provided.

Step 4

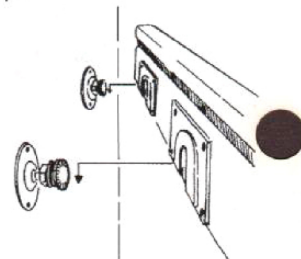

With the clamping nut backed off, slip the handrail and rail piece assembly onto the oval wall bracket so that the rail piece goes over the mounting head of the wall bracket. Now tighten the clamping nut against the rail piece with an open-ended wrench.

### DISTRIBUTED BY:

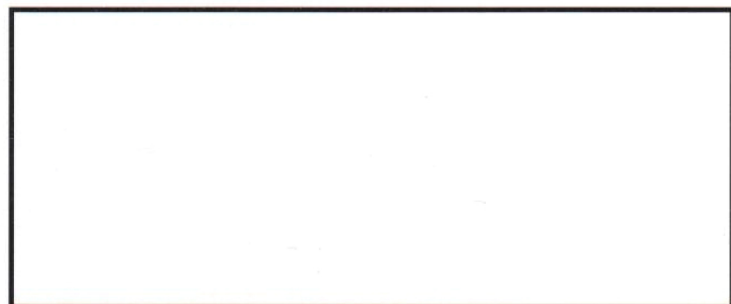

For further information on **RAILOCK** Mounting Brackets or your local distributor, call or write:

Railock Inc.  
431 Lark Ave.  
Maplewood, MN 55117  
651-772-8585

The standard finish is nickel.

Other finishes such as brass, black, etc....are available on a special order basis. Consult your distributor for more information.